

INTERIOR ELEVATION

NOTE #1: STEEL USED IS ASTM A-653 SS GRADE (ei) STRUCTURAL QUALITY GRADE 40. FINISH IS G-90 GALVANIZED OR G-60 GALVANIZED WITH A BAKED ON PRIMER POLYESTER TOP COAT ON BOTH SIDES.

WINDLOCKS STAMPED FROM .130 GALVANIZED STEEL OF COMMERCIAL QUALITY AND RIVETED TO EACH CORRUGATION IN SHEET (5 WINDLOCKS AT EACH END OF EACH SHEET). WINDLOCK ATTACHED WITH TWO 3/16" STEEL POP RIVETS SUPPORTED BY .058 STEEL BACK-UP PLATES ON EXTERIOR OF CURTAIN.

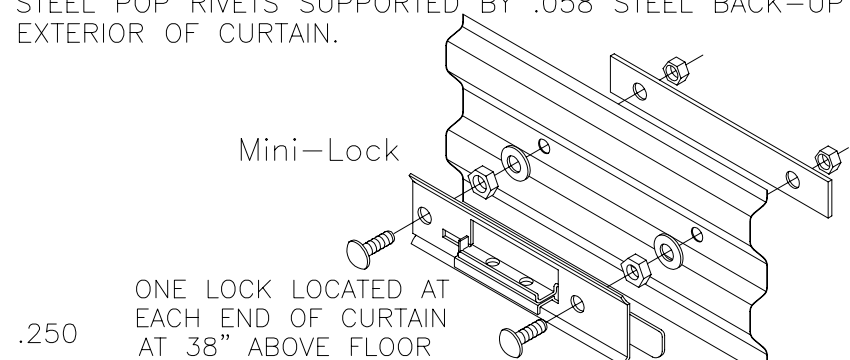

SLIDE BAR LOCK

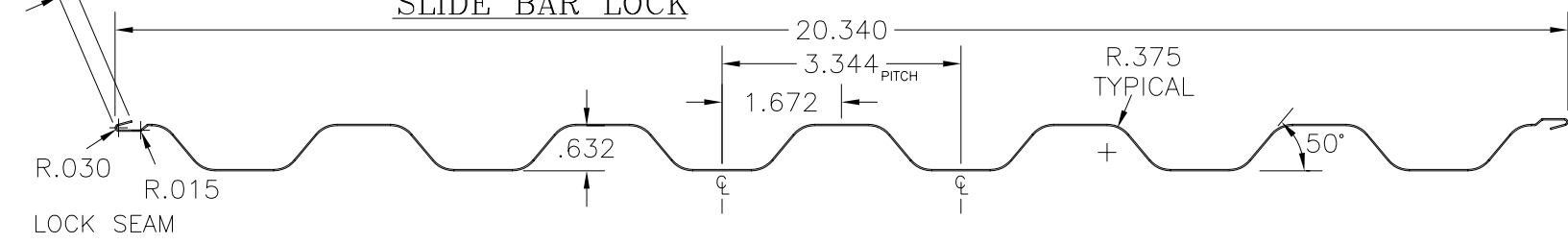

CORRUGATED SHEET

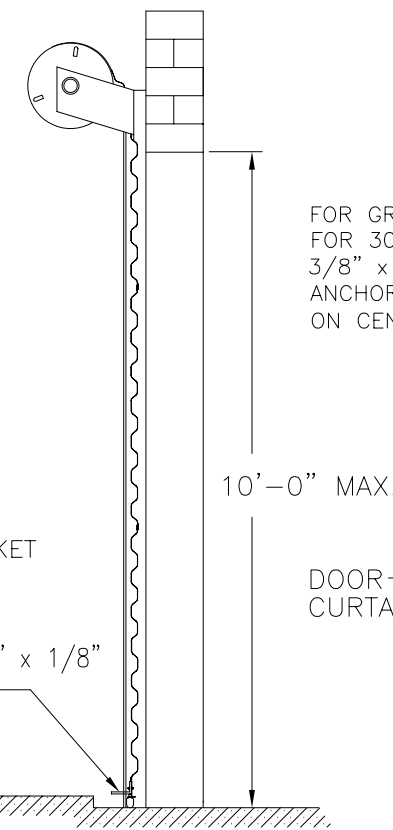

SIDE ELEVATION

FOR GROUT FILL CONCRETE BLOCK OR FOR 3000PSI CONCRETE JAMBS, USE 3/8" x 1 7/8" HILTI STEEL SLEEVE ANCHORS ZINC FINISH, SPACED AT 8" ON CENTER.

FOR GROUT FILL CONCRETE BLOCK OR FOR 3000PSI CONCRETE JAMBS, USE ITW BUILDEX TAPCON ANCHOR 1/4" x 1-1/4" LONG, AND SPACED AT 12" ON CENTER.

FOR .103 STEEL JAMBS, USE ITW/BUILDEX TEK SELF-DRILLING FASTENER 1/4-14 x 3/4" LONG SPACED: 16" ON CENTER WITH THE 14 GA DOOR GUIDE. 8" ON CENTER WITH THE 12 GA TRACK BRACKET.

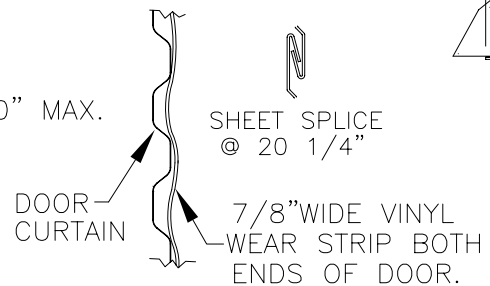

CONCRETE BLOCK FILLED JAMB

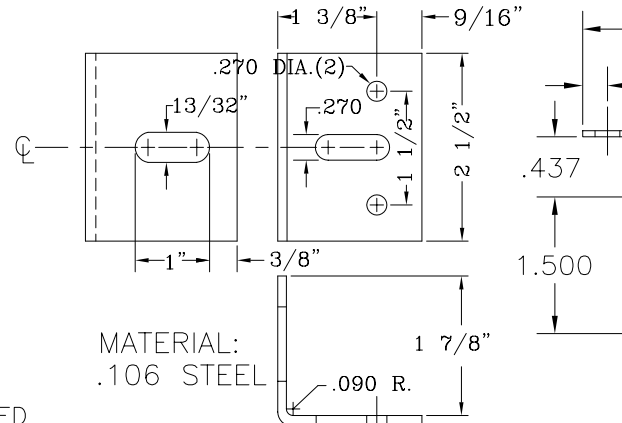

TRACK BRACKET

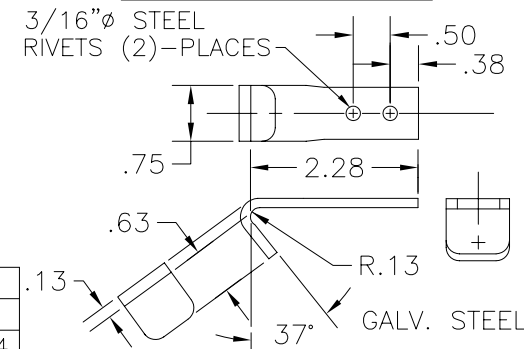

WIND-LOCKS

GUIDE DETAIL

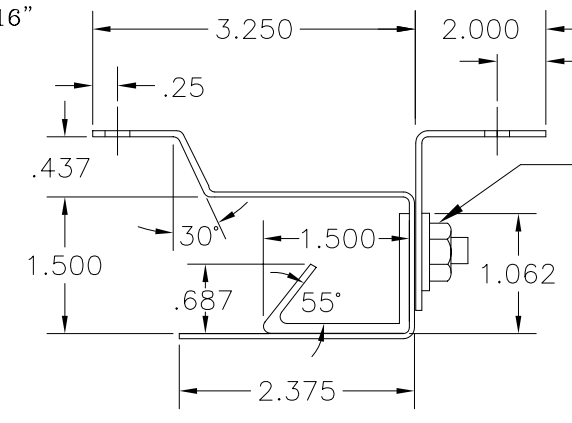

14 GA. (0.075 IN.) MINIMUM THICKNESS

OPENING WIDTH

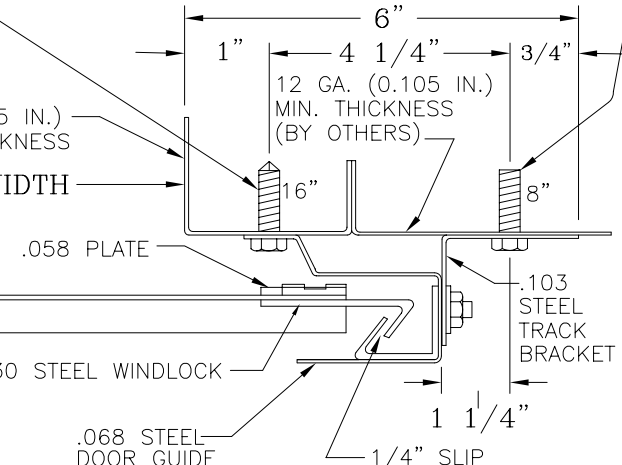

STEEL JAMB

STRUCTURE MUST BE DESIGNED TO SUPPORT FORCES F1, F2 & F3 (SHOWN AS LB/FT OF OPENING HEIGHT) AT EACH JAMB. VALUES ARE SHOWN IN CHART BELOW.

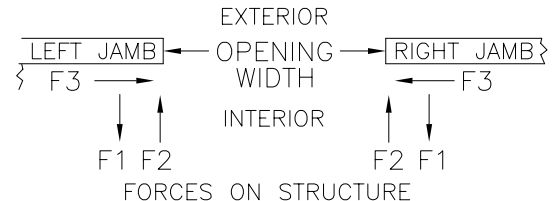

PITCH JAMB TYPE	POSITIVE			NEGATIVE		
	F1	F2	F3	F1	F2	F3
STEEL	235	49	420	141	359	604
CONCRETE BLOCK	235	49	420	141	359	604

MODEL 566-DCC
 MAX. OPENING: 8' WIDE x 10' HEIGHT
 46 PSF POSITIVE/54 PSF NEGATIVE

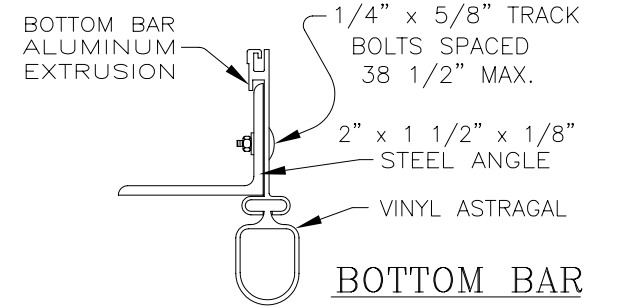

BOTTOM BAR

DOOR	QTY.	WIDTH	HGT.	TYPE OF OPERATION	SPECIAL COMMENTS
3		06-05-05		CHANGED SPACING ON TAPCON ANCHORS	
2		11-29-00		REVISED WEAR STRIP NOTE	
1		03-29-00		ADDED (2)-DETAILS	

MODEL 566-54-96

U.S. Door & Building Components

JOB: _____
 CONTRACTOR: _____
 ARCHITECT: _____
 ADDRESS: _____
 DISTRIBUTOR: _____
 ENGINEER: _____

DATE: 8-2-99 SHEET: 1 of 1
 DRAWN BY: C.D.W.
 CHECKED BY: G.O.G.
 DRAWING NUMBER: 566-54-96

10407 Rocket Blvd. Orlando Fl. 32824
 407.859.6770 Fax 407.447.2923 usdoor.com
 J.H. DIXON JR P.E. LIC No. FL7768

August 2, 1999